



VORTEX
EXTREME®

VARIFORM®
by **Ply Gem**



When it comes to your home, your life and your peace of mind, Variform vinyl siding makes every moment matter. Since 1964, professionals and homeowners alike have trusted Variform for its high quality, durability and beauty, earning it one of the highest satisfaction ratings in the industry.

You can choose from a wide array of styles and one of the largest color palettes in vinyl siding. It's virtually maintenance-free and never needs painting. Plus, Variform is endorsed by Ply Gem Residential Solutions, a division of Cornerstone Building Brands, the nation's leading exterior building products company. The Variform brand has products that make homes beautiful and life easier and offers an impressive limited lifetime transferable warranty.

It all adds up to give you a beautiful home and time to enjoy life's sweetest moments.

A photograph of a child from behind, wearing a bright yellow puffy jacket and red pants, holding a white umbrella with black polka dots. The child is walking on a path with blurred green foliage in the background.

Because
life
happens



High-velocity winds can threaten homes in virtually any part of the country. But when the weather is at its worst, Vortex Extreme® performs at its very best. Designed right in the heart of Tornado Alley where we see the damage that wind can cause, Vortex Extreme vinyl siding is engineered to withstand high winds as the result of what we call Weather Warrior™ Technology. A combination of innovative design, an extra-thick .046" panel, and a standard of design excellence that's second to none. So if you're looking to make an investment to protect your investment, Vortex Extreme is the ideal choice.

Choose with Confidence

As a brand that has spanned generations of building and remodeling, Variform has always been defined by new and innovative ideas. The brand was the first to create variegated technology, a double-staggered nail hem, and a rollover locking leg that have resulted in a more dependable, durable and securely fastened siding panel, even in the face of high-velocity winds. We use only the best raw materials and continuously test our products to ensure a lifetime of reliable performance. We're as committed as ever to great products, so you can be confident you've chosen wisely.



Pictured on cover: Vortex Extreme in Sagebrook

Longer lengths, fewer seams

In addition to standard 12' lengths, longer 16' 8" lengths are available in Double 4" Traditional Lap and Double 4.5" Dutch Lap. The longer lengths minimize the number of seams on a home, especially on long walls with no windows or doors, creating a clean, straight appearance.

12'

16' 8"

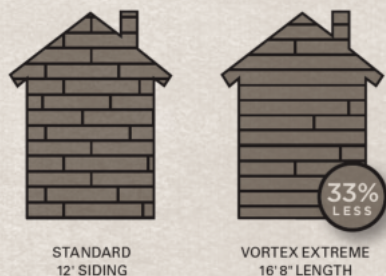

- Longer lengths minimize the number of seams on a home, especially on long walls with no windows or doors.
- Creates a clean, straight appearance.

The look of woodwork without the work of wood

The natural-looking texture of Vortex Extreme replicates the look of split cedar. Its shallow, embossed grain reduces dirt buildup and makes cleaning easy. Just an occasional spray with the garden hose is all it takes. Never scrape, stain or paint your house again.



Vortex Extreme® Double 5" Traditional Lap

Beautiful styles and profiles, authentic shadow lines and extreme protection

Choose from Double 4" and Double 5" Traditional or Double 4.5" Dutch Lap styles, each with a deep $\frac{3}{4}$ " panel projection that adds rigidity and creates dramatic shadow lines. With its realistic wood grain texture and freshly painted look, Vortex Extreme gives you the beauty of wood, but with far more weather protection and far less maintenance.



Double 4" Traditional Lap

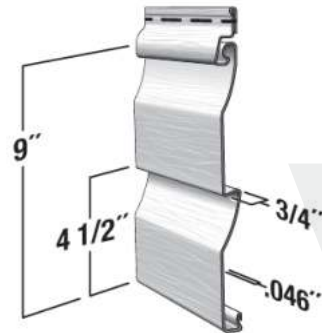

Double 4" Dutch Lap

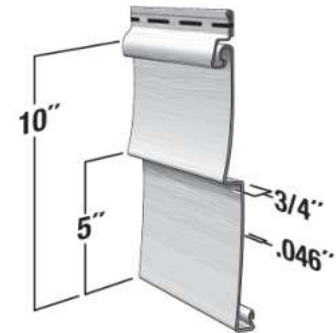

Double 5" Traditional Lap

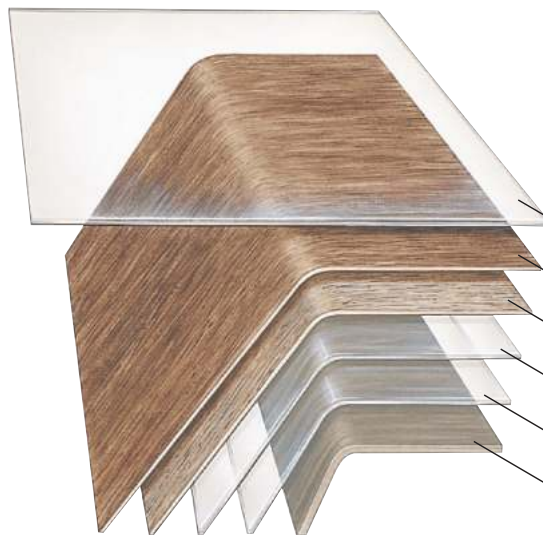

Kynar 500® coating

Cedar colors use Kynar 500®, a multi-layer, weather-resistant coating system that provides ultimate color retention and unmatched protection against the damaging effects of UV rays.

- Kynar 500® (clear coat)
- Print coat 1 (grains / ticking)
- Print coat 2 (shading / undertones)
- Thermal mechanical weld coat 1
- Thermal mechanical weld coat 2
- Solid vinyl substrate

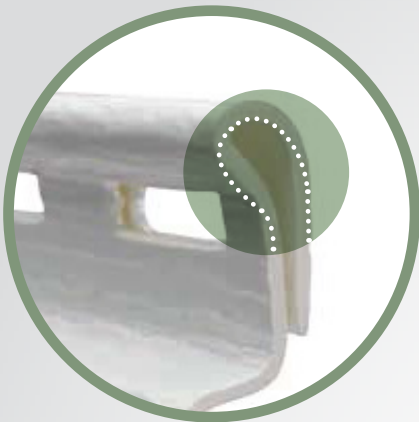

Reverse roll-over nail hem

- Unique, patent-pending design allows for expansion and contraction but holds fast in extreme conditions.
- Double hem provides a two-layer attachment point for extra holding power.
- Circular reinforcement bar on top increases strength and rigidity.
- Circular design helps prevent nails from being driven too tight.



Triple Bow™ locking system

- The curved “bow echo” design of the locking system withstands extreme winds.
- Standard Wind Load Design Pressure (DP) 89.4 PSF* and Wind Velocity 190 mph**.
- Structural channel design adds rigidity, allowing panels to install straight and stay true.
- Reinforced bottom lock design adds interlocking strength where it's needed most.



When Mother Nature visits, make sure the house is ready

To develop one of the toughest siding products available, we took the best known weather technologies out there, engineered them to perform even better and built them all into one siding system. We call this combination of innovative design features Weather Warrior Technology. The result is Vortex Extreme siding. Manufactured to exacting standards and rigorously tested, it protects your home from some of the worst weather conditions your house will ever face.



“Spring-loaded” profile design

- The “spring-loaded” center lap design helps hold panels together so seams stay tight.
- Upward reverse angle butt provides pressure to help keep seams tight and flat against the wall.
- Full $\frac{3}{4}$ " profile design increases rigidity and stability.
- Deep panel projection creates attractive shadow lines.



Color-through technology

- Color is embedded throughout the panel, so your siding looks great year after year.
- Helps hide nicks and scratches.
- Mineral-based pigments deliver long-lasting color.
- Unique formulation provides an added barrier against UV rays and heat buildup.

*Example wind velocity for 89.4 PSF is 190 MPH Zone B @ 30' building height

**Tested in accordance with ASTM D5206. Wind speed rating will vary depending on specific code region and construction method. Refer to local building codes for detailed requirements concerning allowable wind loads and specified conversion tables for actual wind speeds.





VARIFORM®
by  **Ply Gem**

Superior protection for your home and investment.

When you choose Vortex Extreme™ for your home, you're getting siding manufactured using the highest quality materials and the highest standard of quality controls. Before we package our panels, we put them through a 35-point checklist to make sure they meet our exacting standards. We're so confident Vortex Extreme will perform beautifully for years to come that we offer a Limited Lifetime Transferable Warranty that protects against manufacturing defects, excessive color fade and limited hail damage.*

*See warranty for complete details.





Sustainable Building, Responsible Living

We're committed to reducing our impact on the environment and providing products that help ensure a sustainable future.

Sustainable Resources

- Vinyl products made from abundant natural resources¹
- Minimal construction site waste
- Aluminum products contain over 80% recycled content
- Ply Gem facilities reuse and recycle

Energy Efficiency

- Vinyl siding requires less energy to manufacture than brick²
- National distribution network reduces energy use and emissions
- Variform insulated siding increases a home's energy efficiency

Lifecycle Benefits

- Variform vinyl siding is durable and requires no site finish
- Vinyl siding should never require painting or staining
- All of our aluminum accessories are easily recyclable

¹ "A Dozen Things You Might Not Know That Make Vinyl Siding Green," page 9, Tad Radzinski, P.E., LEED AP, and VSI, October 10, 2009. <<http://www.vinylsiding.org/greenpaper/>>

² Ibid, page 10.



Home Innovation
NGBS GREEN PARTNER™

RESOURCE EFFICIENCY

**THIS PRODUCT HAS BEEN
CERTIFIED BY HOME INNOVATION
RESEARCH LABS.**

This means you can be assured that this product complies with specific green practice criteria in the National Green Building Standard (NGBS). Visit HomeInnovation.com/GreenProducts for more details.

**Colors that look
freshly painted,
year after year.**

Variform gives you a full spectrum of choices to express your individual style beautifully. Each color starts with the highest quality pigments blended throughout the panel to ensure consistent color that stands up to everyday dings and scratches.

Light or dark, bold or subtle, Variform colors will add lasting appeal to your home. No painting is ever needed. In addition to our own strict quality controls, they've been third-party tested to meet or exceed ASTM standards for color retention.

Standard Colors

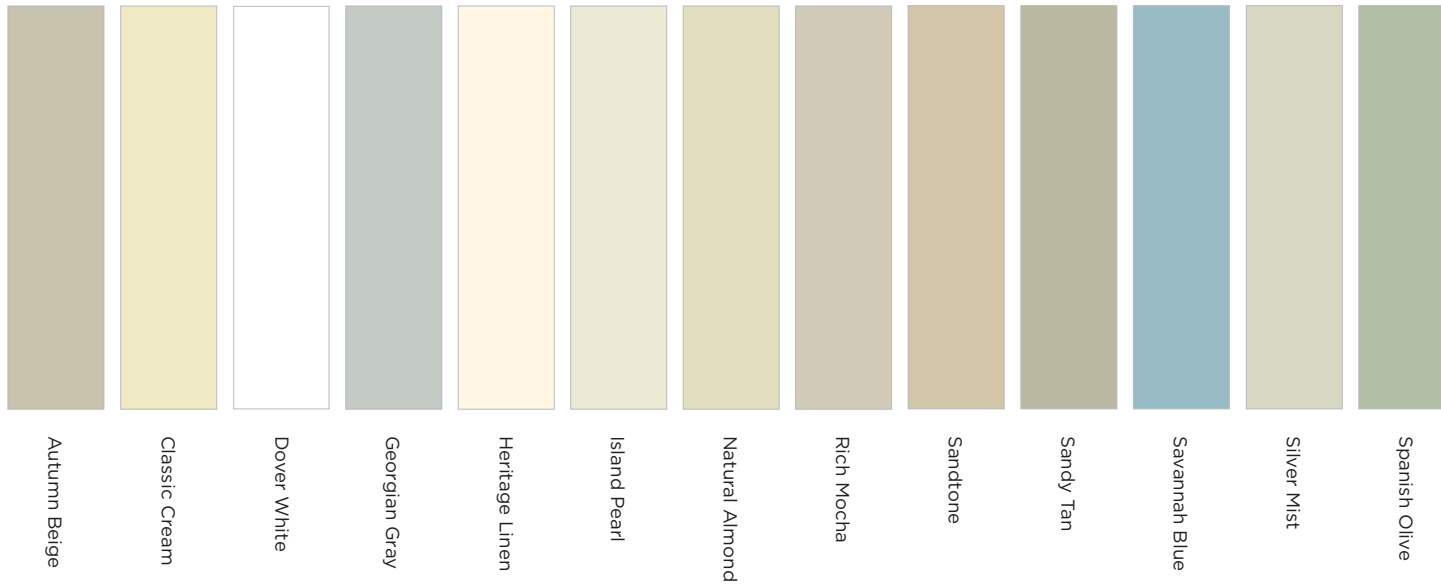

Dark Colors

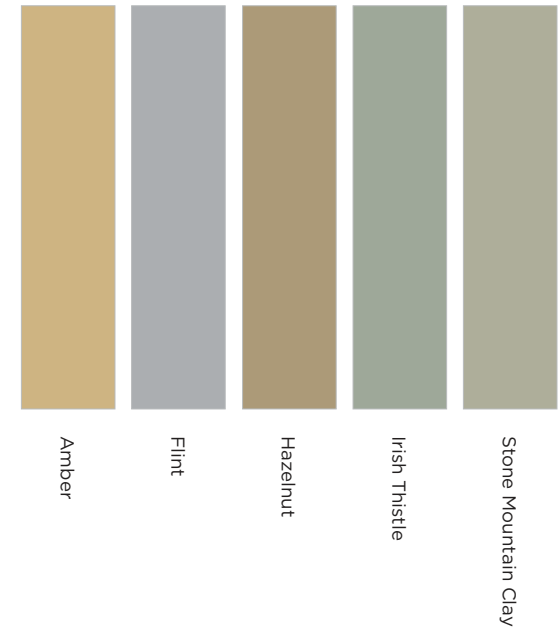



Standard
dark color
siding over
time**

Premium
colors with
Permahue
technology
over time**

Premium Color Collection

These rich, dark colors receive an extra layer of UV protection. Permahue® technology acts like a sunscreen to help prevent fading and weathering.

**Simulation. Fading comparison is based on color tests performed on actual siding samples.

Premium Dark Colors

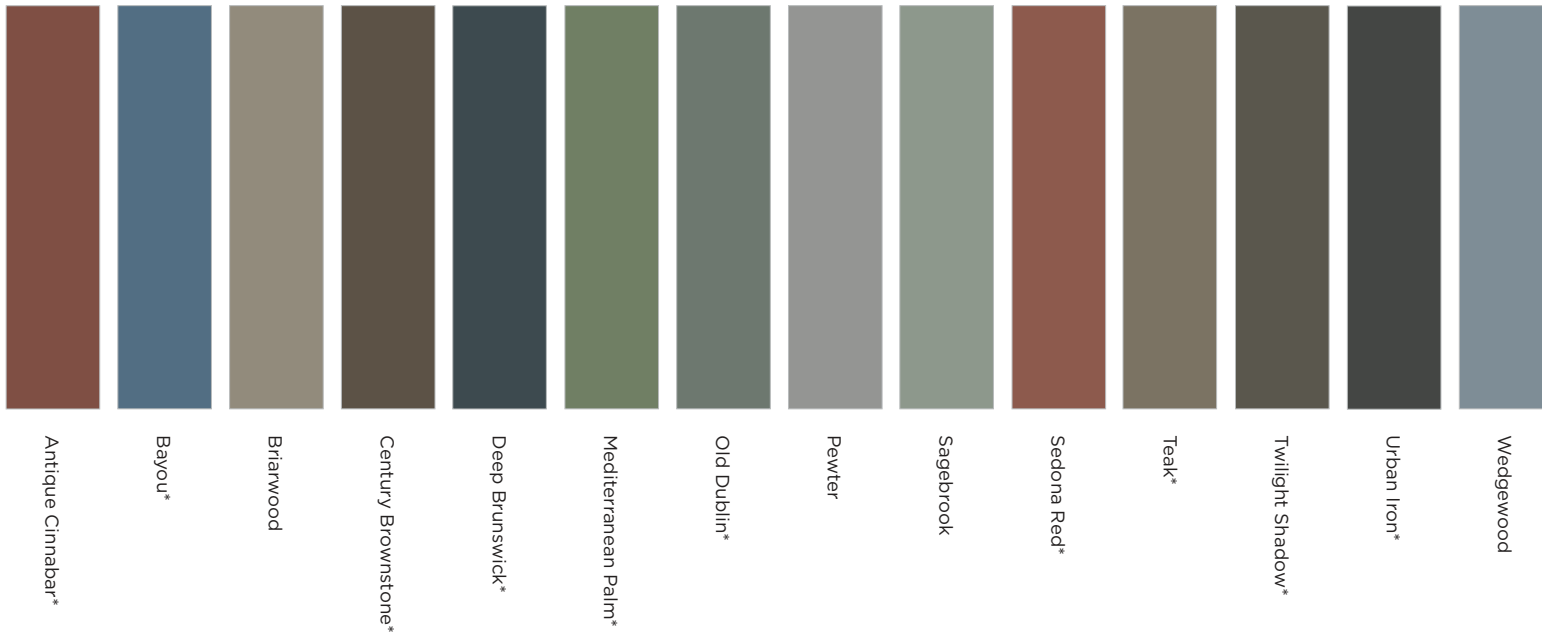

Cedar Color Collection



*These colors are only available in Double 4" Traditional and Double 4.5" Dutch Lap.
Cedar Colors use Kynar 500® weather-resistant coating system



Details, details, details.

The Variform brand has all the accessories and details you need to complete your project, including corners, trim, guttering, soffits, door surrounds and fascia. The Variform brand is endorsed by Ply Gem Residential Solutions, a division of Cornerstone Building Brands, the nation's leading exterior building products company. As a result, we can provide you with a wide range of enhancements that complement Variform products - Ply Gem gutter protection, Ply Gem Steel Siding, Ply Gem Trim and Mouldings, and Ply Gem Shutters and Accents. They all work together so that you can have worry-free maintenance and beauty down to the last detail.

Visit **variform.com** to design your dream home.

2600 Grand Blvd., Suite 900, Kansas City, MO 64108
(888) 9PLYGEM | variform.com



ASTM
D 3679



Cornerstone Building Brands reserves the right to alter, modify or delete items from time to time without notice. Due to printing limitations, colors may not be exactly as shown. Contact your sales representative for actual product and color samples. Variform, the Variform logo, and Vortex Extreme are trademarks of Variform, Inc. © 2019 Variform®, part of the **Cornerstone Building Brands** family. All Rights Reserved. 3309100971104/MS/CG/1019

*Consult the VSI Website at vinylsiding.org for current list of certified products and colors.



Vinyl Siding and Accent Panels



Gutter Protection



Rainware, Fascia, Soffit



Ply Gem Fence and Railing



Ply Gem Steel Siding



Ply Gem Shutters and Accents